

INSTRUCTIONS FOR USE

PrMOUNJARO® KwikPen®

tirzepatide injection

multi-dose prefilled pen for subcutaneous use

Each pen contains 4 fixed doses, one dose taken weekly.

2.5 mg/0.6 mL multi-dose prefilled pen

5 mg/0.6 mL multi-dose prefilled pen

7.5 mg/0.6 mL multi-dose prefilled pen

10 mg/0.6 mL multi-dose prefilled pen

12.5 mg/0.6 mL multi-dose prefilled pen

15 mg/0.6 mL multi-dose prefilled pen



Lilly

Important information you need to know before injecting MOUNJARO KwikPen

Read this “INSTRUCTIONS FOR USE” and the Patient Medication Information each time you use your MOUNJARO KwikPen multi-dose prefilled pen and each time you get a new KwikPen. There may be new information. This information does not take the place of talking to your healthcare professional about your medical condition or your treatment.

Talk to your healthcare professional about how to inject MOUNJARO KwikPen the right way.

- MOUNJARO KwikPen is a multi-dose single-patient-use prefilled pen.
- **One MOUNJARO KwikPen contains 4 doses of 0.6 mL each. One dose is taken each week.**
- Inject one dose each week under the skin (subcutaneously) only.
- After you have taken the 4th dose (a month’s treatment), you will see leftover medicine in the KwikPen. This is normal. The leftover medicine ensures that the KwikPen works correctly. Even though the KwikPen still has medicine in it, **do not use it. Throw it away in a sharps disposal container.** The KwikPen will prevent you from dialing a full dose after you have given yourself the 4th dose. You will not be able to turn the knob after you have given yourself the 4th dose.
- **Do not** transfer the medicine from your KwikPen into a syringe.
- **Do not** inject the leftover medication.
- **Do not** share your MOUNJARO KwikPen with other people, even if the pen needle has been changed. You may give other people a serious infection or get a serious infection from them.
- People who are blind or have vision problems should not use the KwikPen without help from a person trained to use the KwikPen.

Guide to parts

Parts of the MOUNJARO KwikPen multi-dose prefilled pen

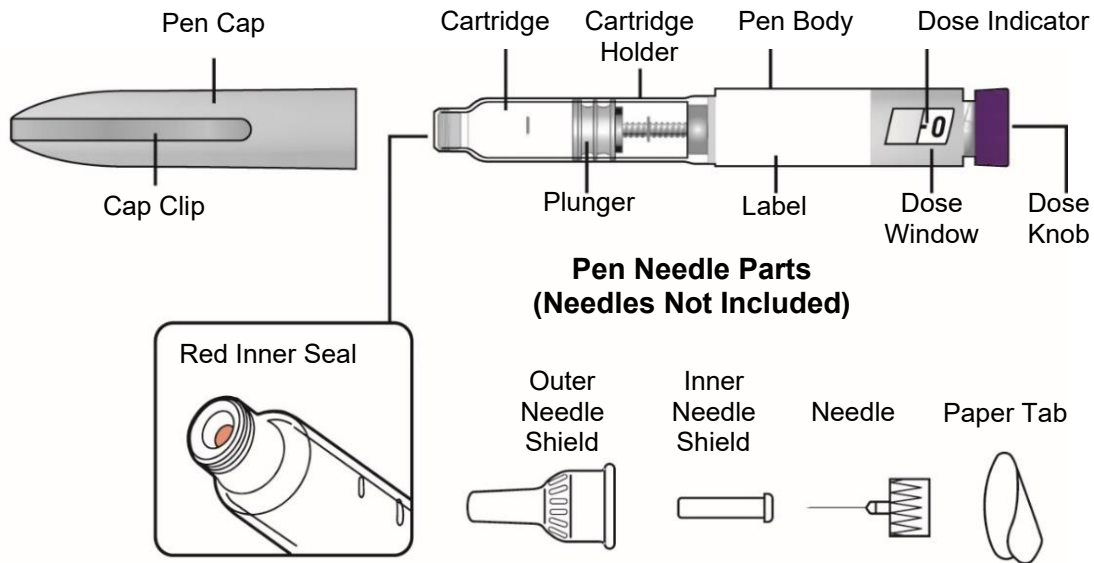

Supplies needed to give your injection

- 1 MOUNJARO KwikPen multi-dose prefilled pen
- 1 pen needle (as recommended by your healthcare professional)
- Alcohol swab
- Gauze or cotton ball
- Sharps disposal container or household container

Preparing to inject MOUNJARO KwikPen

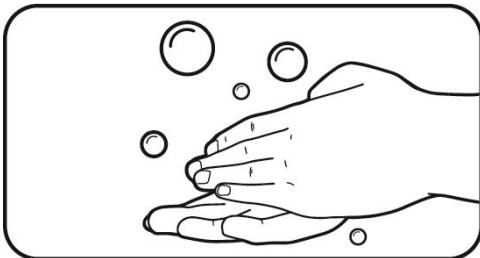

Step 1:

- Wash your hands with soap and water.

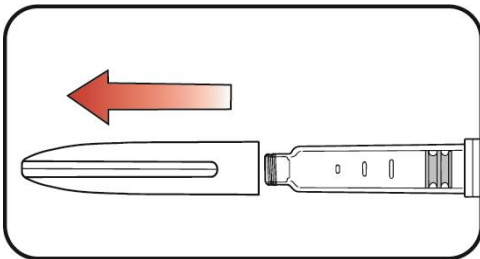

Step 2:

- Pull the KwikPen cap straight off.
- Inspect the KwikPen and label. **Do not** use if:
 - the medication name or dose strength does not match your prescription.
 - the KwikPen is expired (EXP) or looks damaged.
 - the medication has been frozen, has particles, is cloudy, or is discolored. Make sure the medicine in the KwikPen is colourless to slightly yellow.

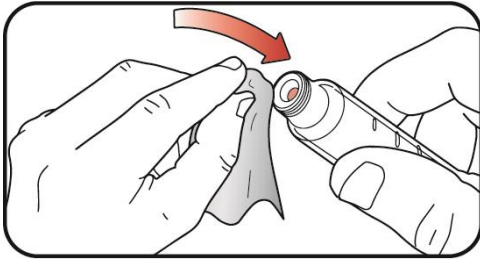

Step 3:

- Wipe the red inner seal with an alcohol swab.

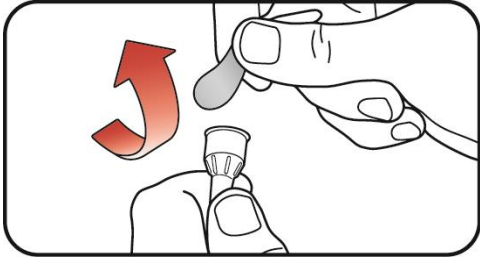

Step 4:

- **Select a new pen needle.** Always use a new pen needle for each injection to help prevent infections and blocked needles.
- Pull off the paper tab from the outer needle shield.

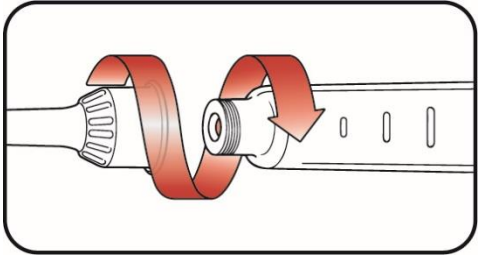

Step 5:

- Push the capped pen needle straight onto the KwikPen and twist the pen needle on until it is tight.

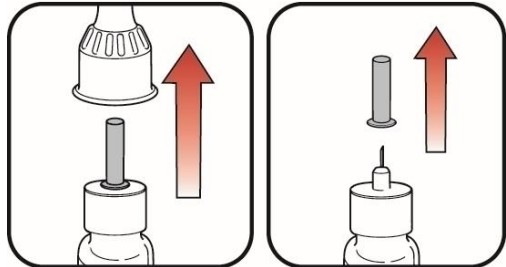

Step 6:

- a. Pull off the outer needle shield and keep it. This will be reused.
- b. Pull off the inner needle shield. Put it in your household trash.

a. Outer needle shield

b. Inner needle shield

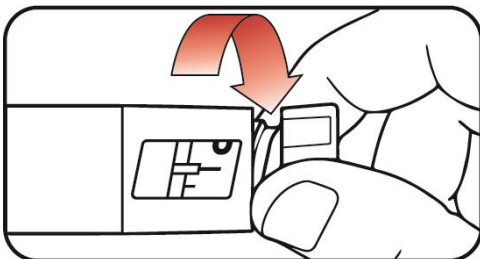

Step 7:

- **Slowly turn** the dose knob until you hear **2 clicks** and the  extended line shown in the dose window aligns with the dose indicator.

This is the **prime position**. It can be corrected by turning the dose knob in either direction until the prime position is achieved.

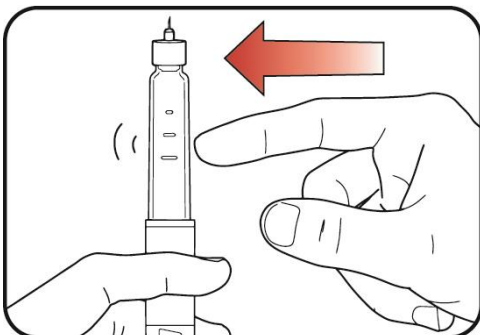

Step 8:

- Hold your KwikPen with the needle pointing up.
- Tap the cartridge holder gently to collect air bubbles at the top.

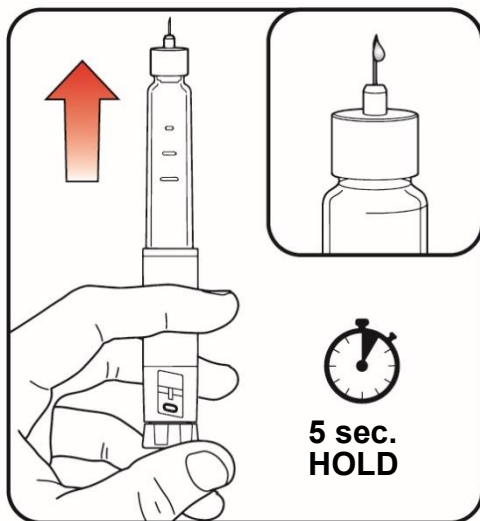

Step 9:

- Release some medicine into the air by **pushing the dose knob in** until it stops, then **slowly count to 5 while holding the dose knob**. The **0** icon must be shown in the dose window. **Do not** inject into your body.

Priming removes air from the cartridge and makes sure that your KwikPen is working correctly. Your KwikPen has been primed if a small amount of medicine comes out of the tip of the pen needle.

- If you do not see medicine at the tip of the needle, repeat **steps 7-9**, no more than 2 additional times.
- If you still do not see medicine, then change the pen needle and repeat **steps 7-9**, no more than 1 additional time.
- If you still do not see medicine, contact Lilly at 1-888-545-5972.

Injecting MOUNJARO KwikPen

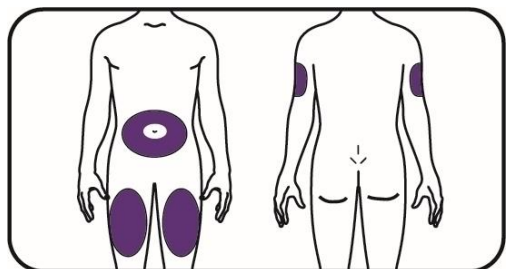

a. Front

b. Back

Step 10:

- Choose an injection site.
 - a. You or another person can inject the medicine in your **thigh** or **stomach** (abdomen) at least 5 centimeters from the belly button (see the image).
 - b. Another person should give you the injection in the **back of your upper arm**.
- **Change (rotate)** your injection site each week. You may use the same area of your body but be sure to choose a different injection site in that area.

Do not inject:

- where the skin has pits, is thickened or has lumps
- where the skin is tender, bruised, scaly or hard
- into scars or damaged skin
- into the same injection site used for other medicines.

Step 11:

- Turn the dose knob until it stops and the **1** icon is shown in the dose window. **The 1 icon is equal to a full dose (0.6 mL).**

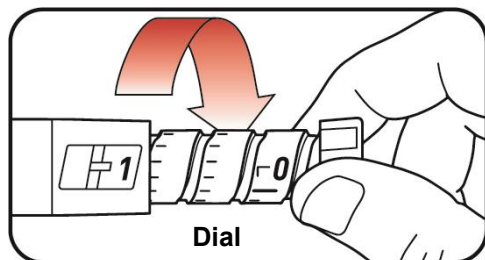

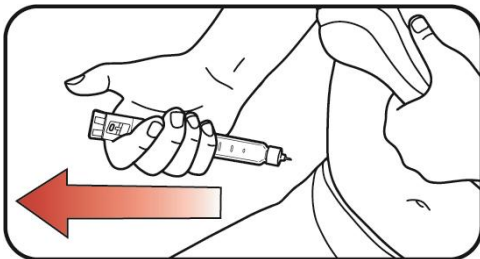
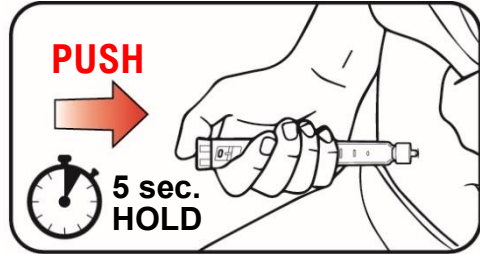
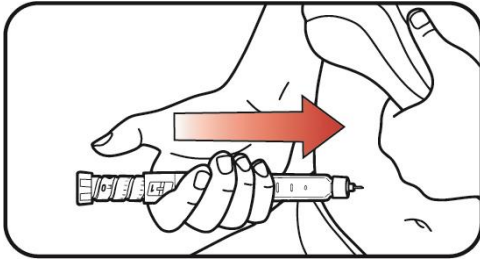

Step 12:

- a. Insert the needle into your skin.
- b. Inject the medicine by **pushing the dose knob in** until it stops. **Hold the dose knob in and slowly count to 5.** The  icon must be shown in the dose window before removing the needle.

Step 13:

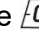
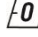
- Pull the needle out of your skin. A drop of medicine on the needle tip is normal. It will not affect your dose.
- Confirm the  icon is in the dose window.
If you see the  icon in the dose window, you have received the full dose.
If you do not see the  icon in the dose window, insert the needle back into your skin and finish your injection. **Do not** redial the dose.
If you still do not think you received the full dose, **do not** start over or repeat the injection. See “Storage and handling” or “Troubleshooting” sections for more information.

After your MOUNJARO KwikPen injection

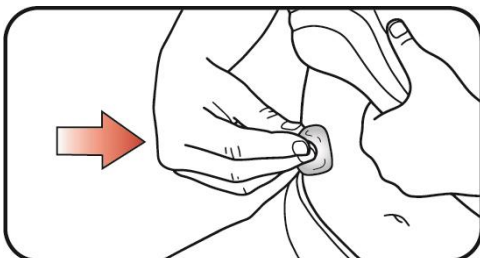

Step 14:

- If you see blood after you pull the needle out of your skin, lightly press the injection site with gauze or a cotton ball. **Do not** rub the injection site.

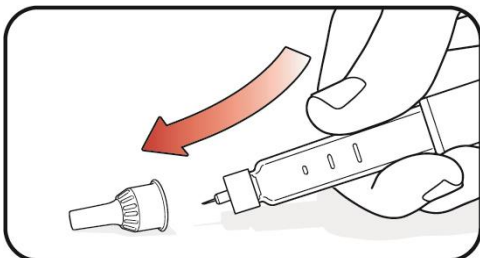

Step 15:

- Carefully replace the outer needle shield.

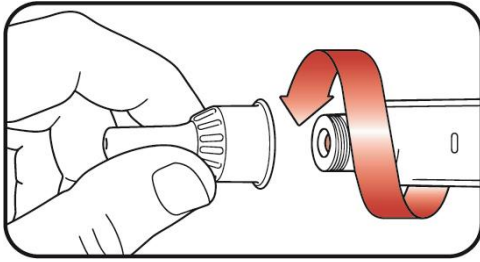

Step 16:

- Unscrew the capped needle and put the needle in a sharps container (see "Disposing of MOUNJARO KwikPen and needles" section).

Do not store the KwikPen with the needle attached to prevent leaking, blocking the needle, and air from entering the KwikPen.

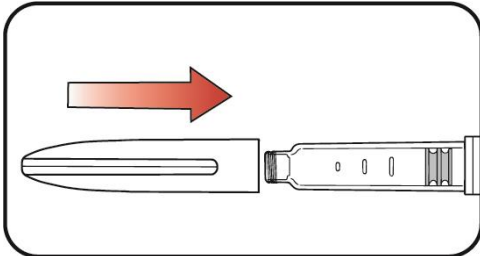

Step 17:

- Replace the KwikPen cap.

Do not store the KwikPen without the pen cap attached.

Storage and handling

Unused KwikPens:

- Store **unused KwikPens** in the **refrigerator** between 2°C to 8°C.
- KwikPens may be used until the expiration date printed on the label if the unused KwikPen has been stored in the refrigerator.
- **Do not** freeze your KwikPen. Throw away the KwikPen in a sharps disposal container if it has been frozen.

Used KwikPens:

- You may store your **used KwikPen** at **room temperature** up to 30°C for up to 30 days.
- Keep away from heat and light.
- Throw away the KwikPen 30 days after first use in a sharps disposal container even if the KwikPen has medication left in it.
- Throw away the KwikPen after receiving the 4 weekly doses contained in the pen in a sharps disposal container. Attempting to inject any leftover medicine could result in an incomplete dose even though the KwikPen still has medication left in it.

Keep your KwikPen, needles, sharps container and all medicines out of the sight and reach of children.

Disposing of MOUNJARO KwikPen and needles

- Put your used pen needles in a sharps disposal container right away after use.
- **Do not** throw away loose pen needles in your household trash.
- MOUNJARO KwikPen contains 4 doses. Discard your KwikPen after using it once per week for 4 weeks (4 doses). Put all used KwikPens into a puncture-resistant (sharps) container once all the doses have been used. There may be some medicine still left in the pen after the 4 weekly doses were given.
- If you do not have a sharps disposal container, you may use a household container that is:
 - made of a heavy-duty plastic,
 - can be closed with a tight-fitting, puncture-resistant lid, without sharps being able to come out,
 - upright and stable during use,
 - leak-resistant, and
 - properly labeled to warn of hazardous waste inside the container.

- When your sharps disposal container is almost full, follow your community guidelines for the right way to dispose of it. There may be local laws about how you should throw away used needles and syringes. Talk to your healthcare professional about how to dispose of your sharps container.
- **Do not** recycle your used sharps disposal container.

Troubleshooting

- If you cannot remove the KwikPen cap, gently twist the KwikPen cap back and forth, and then pull the KwikPen cap straight off.
- If the dose knob is hard to push:
 - pushing the dose knob more slowly will make it easier to inject.
 - your needle may be blocked. Put on a new pen needle and prime the KwikPen.
 - you may have dust, food, or liquid inside the KwikPen. Throw the KwikPen away in a sharps disposal container and get a new KwikPen.
- If the KwikPen prevents you from turning the dose knob until the **1** is in the dose window:
 - Throw away the KwikPen, including the unused medicine in a sharps disposal container. There may not be enough medicine left in the KwikPen to give a full dose. **Do not** attempt to inject the leftover medicine.

Additional Information:



Scan this QR code or visit www.mounjaro.ca for more information on how to use MOUNJARO KwikPen including an instructional video.

For more information, please contact Eli Lilly Canada Incorporated at 1-888-545-5972 or visit the website at www.lilly.ca.

Eli Lilly Canada Inc.
P.O. Box 73
Toronto, ON M5X 1B1

MOUNJARO® and MOUNJARO® KwikPen® are registered trademarks of Eli Lilly and Company, its subsidiaries or affiliates.

Copyright © 2024, 2025, Eli Lilly and Company. All rights reserved.

Issued: JUL 25, 2025

MOU-CA-KP-IFU-0003-20250725

Medication Calendar

Use MOUNJARO KwikPen 1 time a week.

I inject my weekly 0.6 mL dose on the dates below.

Write the day of the week you choose to inject.

Inject on this day each week (Example: Monday).

(Month/Day) (Month/Day) (Month/Day) (Month/Day)

| | | | |
|----------------------|----------------------|----------------------|----------------------|
| <input type="text"/> | <input type="text"/> | <input type="text"/> | <input type="text"/> |
|----------------------|----------------------|----------------------|----------------------|